



SERIE700

Filtri oleodinamici, altissima pressione, in linea, in acciaio zincato e INOX, portata massima 100 l/min, pressione massima 700bar

Serie: 700 in linea

Linea prodotto: Settori Agricolo e Forestale, Movimento Terra, Automotive, Industriale, Marino, Eolico, Trasporto

- Funzionamento in linea
- Compatti e leggeri
- Massima robustezza ed efficienza
- Elevate prestazioni di filtraggio e resistenza
- Con anti-estrusione per sopperire anche ai picchi di pressione più elevati
- Componenti del filtro intercambiabili
- Cartuccia filtrante, sostituibile o lavabile, in bronzo sinterizzato
- Reversibilità del filtro per garantire un filtraggio in entrambe le direzioni del flusso
- Facilità di installazione

Specifiche tecniche:

Pressione massima d'esercizio (bar):	700
Portata massima nominale (l/min):	100
Grado di filtraggio (µm):	10-25-40-60-80/100
Materiale corpo filtro:	Acciaio / INOX
Materiale cartuccia filtrante:	Bronzo sinterizzato
Materiale guarnizioni:	NBR / VITON
Connessione:	BSP / NPTF
Filettatura attacchi:	1/2 " - 1/4 " - 3/8"
Peso (kg):	0,63 (acciaio) - 0,65 (Inox)

Dimensioni:

FILTRO IN LINEA

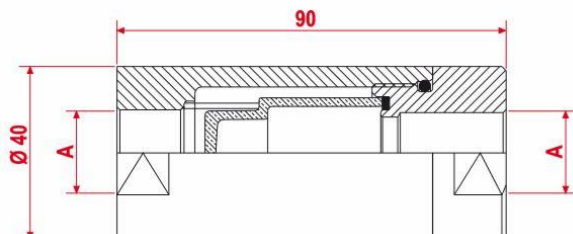

ELEMENTO FILTRANTE INTERNO

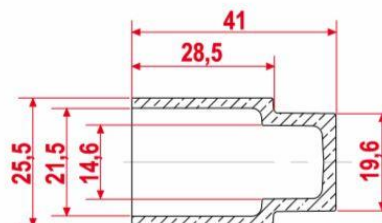



Via F. De Pisis, 5 - 42124 Reggio Emilia (Italy)
 Tel. +39 0522 505 911 - Fax +39 0522 514 204
 E-mail: bell@bell.it - Web-Site: www.bell.it - PEC: bell@pec.bell.it

Per ordinare:

P/N	DESCRIPTION	THREAD	FILTERING	BODY	FLOW	TYPE
926021411	IL700-R 14/10	1 / 4" BSP	10 µ	STEEL	↔	NBR 70SH
926021426	IL700-R 14/25	1 / 4" BSP	25 µ	STEEL	↔	NBR 70SH
926021441	IL700-R 14/40	1 / 4" BSP	40 µ	STEEL	↔	NBR 70SH
926021461	IL700-R 14/60	1 / 4" BSP	60 µ	STEEL	↔	NBR 70SH
926021481	IL700-R 14/80	1 / 4" BSP	80 µ	STEEL	↔	NBR 70SH
926023811	IL700-R 38/10	3 / 8" BSP	10 µ	STEEL	↔	NBR 70SH
926023826	IL700-R 38/25	3 / 8" BSP	25 µ	STEEL	↔	NBR 70SH
926023841	IL700-R 38/40	3 / 8" BSP	40 µ	STEEL	↔	NBR 70SH
926023861	IL700-R 38/60	3 / 8" BSP	60 µ	STEEL	↔	NBR 70SH
926023881	IL700-R 38/80	3 / 8" BSP	80 µ	STEEL	↔	NBR 70SH
926021811	IL700-R 18/10	M18X1,5	10 µ	STEEL	↔	NBR 70SH
926021826	IL700-R 18/25	M18X1,5	25 µ	STEEL	↔	NBR 70SH
926021841	IL700-R 18/40	M18X1,5	40 µ	STEEL	↔	NBR 70SH
926021861	IL700-R 18/60	M18X1,5	60 µ	STEEL	↔	NBR 70SH
926021881	IL700-R 18/80	M18X1,5	80 µ	STEEL	↔	NBR 70SH
926021211	IL700-R 12/10	1 / 2" BSP	25 µ	STEEL	↔	NBR 70SH
926021226	IL700-R 12/25	1 / 2" BSP	25 µ	STEEL	↔	NBR 70SH
926021241	IL700-R 12/40	1 / 2" BSP	40 µ	STEEL	↔	NBR 70SH
926021261	IL700-R 12/60	1 / 2" BSP	60 µ	STEEL	↔	NBR 70SH
926021281	IL700-R 12/80	1 / 2" BSP	80 µ	STEEL	↔	NBR 70SH
926021413	IL700-R 14/10	1 / 4" BSP	10 µ	STEEL	↔	VITON
926021429	IL700-R 14/25	1 / 4" BSP	25 µ	STEEL	↔	VITON
926021443	IL700-R 14/40	1 / 4" BSP	40 µ	STEEL	↔	VITON
926021463	IL700-R 14/60	1 / 4" BSP	60 µ	STEEL	↔	VITON
926021483	IL700-R 14/80	1 / 4" BSP	80 µ	STEEL	↔	VITON
926023813	IL700-R 38/10	3 / 8" BSP	10 µ	STEEL	↔	VITON
926023829	IL700-R 38/25	3 / 8" BSP	25 µ	STEEL	↔	VITON
926023843	IL700-R 38/40	3 / 8" BSP	40 µ	STEEL	↔	VITON
926023863	IL700-R 38/60	3 / 8" BSP	60 µ	STEEL	↔	VITON
926023883	IL700-R 38/80	3 / 8" BSP	80 µ	STEEL	↔	VITON
926021813	IL700-R 18/10	M18X1,5	10 µ	STEEL	↔	VITON
926021829	IL700-R 18/25	M18X1,5	25 µ	STEEL	↔	VITON
926021843	IL700-R 18/40	M18X1,5	40 µ	STEEL	↔	VITON
926021863	IL700-R 18/60	M18X1,5	60 µ	STEEL	↔	VITON
926021883	IL700-R 18/80	M18X1,5	80 µ	STEEL	↔	VITON
926021213	IL700-R 12/10	1 / 2" BSP	25 µ	STEEL	↔	VITON
926021229	IL700-R 12/25	1 / 2" BSP	25 µ	STEEL	↔	VITON
926021243	IL700-R 12/40	1 / 2" BSP	40 µ	STEEL	↔	VITON
926021263	IL700-R 12/60	1 / 2" BSP	60 µ	STEEL	↔	VITON
926021283	IL700-R 12/80	1 / 2" BSP	80 µ	STEEL	↔	VITON
926021417	IL700-R 14/10	1 / 4" BSP	10 µ	STEEL	↔	NBR 90SH
926021432	IL700-R 14/25	1 / 4" BSP	25 µ	STEEL	↔	NBR 90SH
926021447	IL700-R 14/40	1 / 4" BSP	40 µ	STEEL	↔	NBR 90SH
926021467	IL700-R 14/60	1 / 4" BSP	60 µ	STEEL	↔	NBR 90SH
926021487	IL700-R 14/80	1 / 4" BSP	80 µ	STEEL	↔	NBR 90SH
926023817	IL700-R 38/10	3 / 8" BSP	10 µ	STEEL	↔	NBR 90SH
926023832	IL700-R 38/25	3 / 8" BSP	25 µ	STEEL	↔	NBR 90SH
926023847	IL700-R 38/40	3 / 8" BSP	40 µ	STEEL	↔	NBR 90SH
926023867	IL700-R 38/60	3 / 8" BSP	60 µ	STEEL	↔	NBR 90SH
926023887	IL700-R 38/80	3 / 8" BSP	80 µ	STEEL	↔	NBR 90SH
926021817	IL700-R 18/10	M18X1,5	10 µ	STEEL	↔	NBR 90SH
926021832	IL700-R 18/25	M18X1,5	25 µ	STEEL	↔	NBR 90SH
926021847	IL700-R 18/40	M18X1,5	40 µ	STEEL	↔	NBR 90SH
926021867	IL700-R 18/60	M18X1,5	60 µ	STEEL	↔	NBR 90SH
926021887	IL700-R 18/80	M18X1,5	80 µ	STEEL	↔	NBR 90SH
926011217	IL700-R 12/10	1 / 2" BSP	25 µ	INOX 316L	↔	NBR 90SH
926011232	IL700-R 12/25	1 / 2" BSP	25 µ	INOX 316L	↔	NBR 90SH
926011247	IL700-R 12/40	1 / 2" BSP	40 µ	INOX 316L	↔	NBR 90SH
926011267	IL700-R 12/60	1 / 2" BSP	60 µ	INOX 316L	↔	NBR 90SH
926011287	IL700-R 12/80	1 / 2" BSP	80 µ	INOX 316L	↔	NBR 90SH



Via F. De Pisis, 5 - 42124 Reggio Emilia (Italy)
 Tel. +39 0522 505 911 - Fax +39 0522 514 204
 E-mail: bell@bell.it - Web-Site: www.bell.it - PEC: bell@pec.bell.it

P/N	DESCRIPTION	THREAD	FILTERING	BODY	FLOW	TYPE
926011411	IL700-R 14/10	1 / 4" BSP	10 µ	INOX 316L	↔	NBR 70SH
926011426	IL700-R 14/25	1 / 4" BSP	25 µ	INOX 316L	↔	NBR 70SH
926011441	IL700-R 14/40	1 / 4" BSP	40 µ	INOX 316L	↔	NBR 70SH
926011461	IL700-R 14/60	1 / 4" BSP	60 µ	INOX 316L	↔	NBR 70SH
926011481	IL700-R 14/80	1 / 4" BSP	80 µ	INOX 316L	↔	NBR 70SH
926013811	IL700-R 38/10	3 / 8" BSP	10 µ	INOX 316L	↔	NBR 70SH
926013826	IL700-R 38/25	3 / 8" BSP	25 µ	INOX 316L	↔	NBR 70SH
926013841	IL700-R 38/40	3 / 8" BSP	40 µ	INOX 316L	↔	NBR 70SH
926013861	IL700-R 38/60	3 / 8" BSP	60 µ	INOX 316L	↔	NBR 70SH
926013881	IL700-R 38/80	3 / 8" BSP	80 µ	INOX 316L	↔	NBR 70SH
926011811	IL700-R 18/10	M18X1,5	10 µ	INOX 316L	↔	NBR 70SH
926011826	IL700-R 18/25	M18X1,5	25 µ	INOX 316L	↔	NBR 70SH
926011841	IL700-R 18/40	M18X1,5	40 µ	INOX 316L	↔	NBR 70SH
926011861	IL700-R 18/60	M18X1,5	60 µ	INOX 316L	↔	NBR 70SH
926011881	IL700-R 18/80	M18X1,5	80 µ	INOX 316L	↔	NBR 70SH
926011211	IL700-R 12/10	1 / 2" BSP	25 µ	INOX 316L	↔	NBR 70SH
926011226	IL700-R 12/25	1 / 2" BSP	25 µ	INOX 316L	↔	NBR 70SH
926011241	IL700-R 12/40	1 / 2" BSP	40 µ	INOX 316L	↔	NBR 70SH
926011261	IL700-R 12/60	1 / 2" BSP	60 µ	INOX 316L	↔	NBR 70SH
926011281	IL700-R 12/80	1 / 2" BSP	80 µ	INOX 316L	↔	NBR 70SH
926011413	IL700-R 14/10	1 / 4" BSP	10 µ	INOX 316L	↔	VITON
926011429	IL700-R 14/25	1 / 4" BSP	25 µ	INOX 316L	↔	VITON
926011443	IL700-R 14/40	1 / 4" BSP	40 µ	INOX 316L	↔	VITON
926011463	IL700-R 14/60	1 / 4" BSP	60 µ	INOX 316L	↔	VITON
926011483	IL700-R 14/80	1 / 4" BSP	80 µ	INOX 316L	↔	VITON
926013813	IL700-R 38/10	3 / 8" BSP	10 µ	INOX 316L	↔	VITON
926013829	IL700-R 38/25	3 / 8" BSP	25 µ	INOX 316L	↔	VITON
926013843	IL700-R 38/40	3 / 8" BSP	40 µ	INOX 316L	↔	VITON
926013863	IL700-R 38/60	3 / 8" BSP	60 µ	INOX 316L	↔	VITON
926013883	IL700-R 38/80	3 / 8" BSP	80 µ	INOX 316L	↔	VITON
926011813	IL700-R 18/10	M18X1,5	10 µ	INOX 316L	↔	VITON
926011829	IL700-R 18/25	M18X1,5	25 µ	INOX 316L	↔	VITON
926011843	IL700-R 18/40	M18X1,5	40 µ	INOX 316L	↔	VITON
926011863	IL700-R 18/60	M18X1,5	60 µ	INOX 316L	↔	VITON
926011883	IL700-R 18/80	M18X1,5	80 µ	INOX 316L	↔	VITON
926011213	IL700-R 12/10	1 / 2" BSP	25 µ	INOX 316L	↔	VITON
926011229	IL700-R 12/25	1 / 2" BSP	25 µ	INOX 316L	↔	VITON
926011243	IL700-R 12/40	1 / 2" BSP	40 µ	INOX 316L	↔	VITON
926011263	IL700-R 12/60	1 / 2" BSP	60 µ	INOX 316L	↔	VITON
926011283	IL700-R 12/80	1 / 2" BSP	80 µ	INOX 316L	↔	VITON
926011417	IL700-R 14/10	1 / 4" BSP	10 µ	INOX 316L	↔	NBR 90SH
926011432	IL700-R 14/25	1 / 4" BSP	25 µ	INOX 316L	↔	NBR 90SH
926011447	IL700-R 14/40	1 / 4" BSP	40 µ	INOX 316L	↔	NBR 90SH
926011467	IL700-R 14/60	1 / 4" BSP	60 µ	INOX 316L	↔	NBR 90SH
926011487	IL700-R 14/80	1 / 4" BSP	80 µ	INOX 316L	↔	NBR 90SH
926013817	IL700-R 38/10	3 / 8" BSP	10 µ	INOX 316L	↔	NBR 90SH
926013832	IL700-R 38/25	3 / 8" BSP	25 µ	INOX 316L	↔	NBR 90SH
926013847	IL700-R 38/40	3 / 8" BSP	40 µ	INOX 316L	↔	NBR 90SH
926013867	IL700-R 38/60	3 / 8" BSP	60 µ	INOX 316L	↔	NBR 90SH
926013887	IL700-R 38/80	3 / 8" BSP	80 µ	INOX 316L	↔	NBR 90SH
926011817	IL700-R 18/10	M18X1,5	10 µ	INOX 316L	↔	NBR 90SH
926011832	IL700-R 18/25	M18X1,5	25 µ	INOX 316L	↔	NBR 90SH
926011847	IL700-R 18/40	M18X1,5	40 µ	INOX 316L	↔	NBR 90SH
926011867	IL700-R 18/60	M18X1,5	60 µ	INOX 316L	↔	NBR 90SH
926011887	IL700-R 18/80	M18X1,5	80 µ	INOX 316L	↔	NBR 90SH
926011217	IL700-R 12/10	1 / 2" BSP	25 µ	INOX 316L	↔	NBR 90SH
926011232	IL700-R 12/25	1 / 2" BSP	25 µ	INOX 316L	↔	NBR 90SH
926011247	IL700-R 12/40	1 / 2" BSP	40 µ	INOX 316L	↔	NBR 90SH
926011267	IL700-R 12/60	1 / 2" BSP	60 µ	INOX 316L	↔	NBR 90SH
926011287	IL700-R 12/80	1 / 2" BSP	80 µ	INOX 316L	↔	NBR 90SH
926021411	IL700-R 14/10	1 / 4" BSP	10 µ	STEEL	↔	NBR 70SH
926021426	IL700-R 14/25	1 / 4" BSP	25 µ	STEEL	↔	NBR 70SH



Via F. De Pisis, 5 - 42124 Reggio Emilia (Italy)
 Tel. +39 0522 505 911 - Fax +39 0522 514 204
 E-mail: bell@bell.it - Web-Site: www.bell.it - PEC: bell@pec.bell.it

P/N	DESCRIPTION	THREAD	FILTERING	BODY	FLOW	TYPE
926021441	IL700-R 14/40	1 / 4" BSP	40 µ	STEEL	↔	NBR 70SH
926021461	IL700-R 14/60	1 / 4" BSP	60 µ	STEEL	↔	NBR 70SH
926021481	IL700-R 14/80	1 / 4" BSP	80 µ	STEEL	↔	NBR 70SH
926023811	IL700-R 38/10	3 / 8" BSP	10 µ	STEEL	↔	NBR 70SH
926023826	IL700-R 38/25	3 / 8" BSP	25 µ	STEEL	↔	NBR 70SH
926023841	IL700-R 38/40	3 / 8" BSP	40 µ	STEEL	↔	NBR 70SH
926023861	IL700-R 38/60	3 / 8" BSP	60 µ	STEEL	↔	NBR 70SH
926023881	IL700-R 38/80	3 / 8" BSP	80 µ	STEEL	↔	NBR 70SH
926021811	IL700-R 18/10	M18X1,5	10 µ	STEEL	↔	NBR 70SH
926021826	IL700-R 18/25	M18X1,5	25 µ	STEEL	↔	NBR 70SH
926021841	IL700-R 18/40	M18X1,5	40 µ	STEEL	↔	NBR 70SH
926021861	IL700-R 18/60	M18X1,5	60 µ	STEEL	↔	NBR 70SH
926021881	IL700-R 18/80	M18X1,5	80 µ	STEEL	↔	NBR 70SH
926021211	IL700-R 12/10	1 / 2" BSP	25 µ	STEEL	↔	NBR 70SH
926021226	IL700-R 12/25	1 / 2" BSP	25 µ	STEEL	↔	NBR 70SH
926021241	IL700-R 12/40	1 / 2" BSP	40 µ	STEEL	↔	NBR 70SH
926021261	IL700-R 12/60	1 / 2" BSP	60 µ	STEEL	↔	NBR 70SH
926021281	IL700-R 12/80	1 / 2" BSP	80 µ	STEEL	↔	NBR 70SH
926021413	IL700-R 14/10	1 / 4" BSP	10 µ	STEEL	↔	VITON
926021429	IL700-R 14/25	1 / 4" BSP	25 µ	STEEL	↔	VITON
926021443	IL700-R 14/40	1 / 4" BSP	40 µ	STEEL	↔	VITON
926021463	IL700-R 14/60	1 / 4" BSP	60 µ	STEEL	↔	VITON
926021483	IL700-R 14/80	1 / 4" BSP	80 µ	STEEL	↔	VITON
926023813	IL700-R 38/10	3 / 8" BSP	10 µ	STEEL	↔	VITON
926023829	IL700-R 38/25	3 / 8" BSP	25 µ	STEEL	↔	VITON
926023843	IL700-R 38/40	3 / 8" BSP	40 µ	STEEL	↔	VITON
926023863	IL700-R 38/60	3 / 8" BSP	60 µ	STEEL	↔	VITON
926023883	IL700-R 38/80	3 / 8" BSP	80 µ	STEEL	↔	VITON
926021813	IL700-R 18/10	M18X1,5	10 µ	STEEL	↔	VITON
926021829	IL700-R 18/25	M18X1,5	25 µ	STEEL	↔	VITON
926021843	IL700-R 18/40	M18X1,5	40 µ	STEEL	↔	VITON
926021863	IL700-R 18/60	M18X1,5	60 µ	STEEL	↔	VITON
926021883	IL700-R 18/80	M18X1,5	80 µ	STEEL	↔	VITON
926021213	IL700-R 12/10	1 / 2" BSP	25 µ	STEEL	↔	VITON
926021229	IL700-R 12/25	1 / 2" BSP	25 µ	STEEL	↔	VITON
926021243	IL700-R 12/40	1 / 2" BSP	40 µ	STEEL	↔	VITON
926021263	IL700-R 12/60	1 / 2" BSP	60 µ	STEEL	↔	VITON
926021283	IL700-R 12/80	1 / 2" BSP	80 µ	STEEL	↔	VITON
926021417	IL700-R 14/10	1 / 4" BSP	10 µ	STEEL	↔	NBR 90SH
926021432	IL700-R 14/25	1 / 4" BSP	25 µ	STEEL	↔	NBR 90SH
926021447	IL700-R 14/40	1 / 4" BSP	40 µ	STEEL	↔	NBR 90SH
926021467	IL700-R 14/60	1 / 4" BSP	60 µ	STEEL	↔	NBR 90SH
926021487	IL700-R 14/80	1 / 4" BSP	80 µ	STEEL	↔	NBR 90SH
926023817	IL700-R 38/10	3 / 8" BSP	10 µ	STEEL	↔	NBR 90SH
926023832	IL700-R 38/25	3 / 8" BSP	25 µ	STEEL	↔	NBR 90SH
926023847	IL700-R 38/40	3 / 8" BSP	40 µ	STEEL	↔	NBR 90SH
926023867	IL700-R 38/60	3 / 8" BSP	60 µ	STEEL	↔	NBR 90SH
926023887	IL700-R 38/80	3 / 8" BSP	80 µ	STEEL	↔	NBR 90SH
926021817	IL700-R 18/10	M18X1,5	10 µ	STEEL	↔	NBR 90SH
926021832	IL700-R 18/25	M18X1,5	25 µ	STEEL	↔	NBR 90SH
926021847	IL700-R 18/40	M18X1,5	40 µ	STEEL	↔	NBR 90SH
926021867	IL700-R 18/60	M18X1,5	60 µ	STEEL	↔	NBR 90SH
926021887	IL700-R 18/80	M18X1,5	80 µ	STEEL	↔	NBR 90SH
926011217	IL700-R 12/10	1 / 2" BSP	25 µ	INOX 316L	↔	NBR 90SH
926011232	IL700-R 12/25	1 / 2" BSP	25 µ	INOX 316L	↔	NBR 90SH
926011247	IL700-R 12/40	1 / 2" BSP	40 µ	INOX 316L	↔	NBR 90SH
926011267	IL700-R 12/60	1 / 2" BSP	60 µ	INOX 316L	↔	NBR 90SH
926011287	IL700-R 12/80	1 / 2" BSP	80 µ	INOX 316L	↔	NBR 90SH
926011411	IL700-R 14/10	1 / 4" BSP	10 µ	INOX 316L	↔	NBR 70SH
926011426	IL700-R 14/25	1 / 4" BSP	25 µ	INOX 316L	↔	NBR 70SH
926011441	IL700-R 14/40	1 / 4" BSP	40 µ	INOX 316L	↔	NBR 70SH
926011461	IL700-R 14/60	1 / 4" BSP	60 µ	INOX 316L	↔	NBR 70SH



Via F. De Pisis, 5 - 42124 Reggio Emilia (Italy)
Tel. +39 0522 505 911 - Fax +39 0522 514 204
E-mail: bell@bell.it - Web-Site: www.bell.it - PEC: bell@pec.bell.it

P/N	DESCRIPTION	THREAD	FILTERING	BODY	FLOW	TYPE
926011481	IL700-R 14/80	1 / 4" BSP	80 µ	INOX 316L	↔	NBR 70SH
926013811	IL700-R 38/10	3 / 8" BSP	10 µ	INOX 316L	↔	NBR 70SH
926013826	IL700-R 38/25	3 / 8" BSP	25 µ	INOX 316L	↔	NBR 70SH
926013841	IL700-R 38/40	3 / 8" BSP	40 µ	INOX 316L	↔	NBR 70SH
926013861	IL700-R 38/60	3 / 8" BSP	60 µ	INOX 316L	↔	NBR 70SH
926013881	IL700-R 38/80	3 / 8" BSP	80 µ	INOX 316L	↔	NBR 70SH
926011811	IL700-R 18/10	M18X1,5	10 µ	INOX 316L	↔	NBR 70SH
926011826	IL700-R 18/25	M18X1,5	25 µ	INOX 316L	↔	NBR 70SH

Marcatura filtro:

I filtri in linea della Serie 700, così come tutti i filtri BELL, vengono marcati per tipologia, brand, attacco, data di produzione e operatore. Marcatura personalizzata su richiesta.



Tutti i prodotti BELL sono progettati e realizzati all'interno di BELL SRL in via F. De Pisis, 5 – 42124 Reggio Emilia (RE) – Italia, secondo i canoni di Qualità che contraddistinguono il MADE IN ITALY dal resto del Mondo.