

Ultra Air Pump H₂O

UPW250-H²O

Pneumatic motor, for water use (H₂O), water flow rate from the water mains, water pressure up to 250bar, without tank

Series: UP-H2O

Product line: thermo-hydraulic, thermo-sanitary, civic network, industrial network, control units for testing

- Complete pneumatic motor, ready for installation
- It works through the normal water supply (H₂O)
- Single/Double acting
- Easy maintenance
- Adjustable max water pressure relief valve
- Integral brass pump body
- Stainless steel pump piston

Technical features:

Max working pressure (bar):	250
Cylinder compatibility:	Single/Double acting
Max water flow nominal (l/min):	0,7
Max water flow without load (l/min):	2,6
Max water flow with load (l/min):	0,7
Water port:	G1/4" - INOX
Inlet port:	G1/4"
Power source:	Water
Source of use:	Water H ₂ O
Pneumatic range (bar):	/
Average air consumption (l/min):	/
Noise (dBA):	/
Weight (Kg):	1,5

Size:

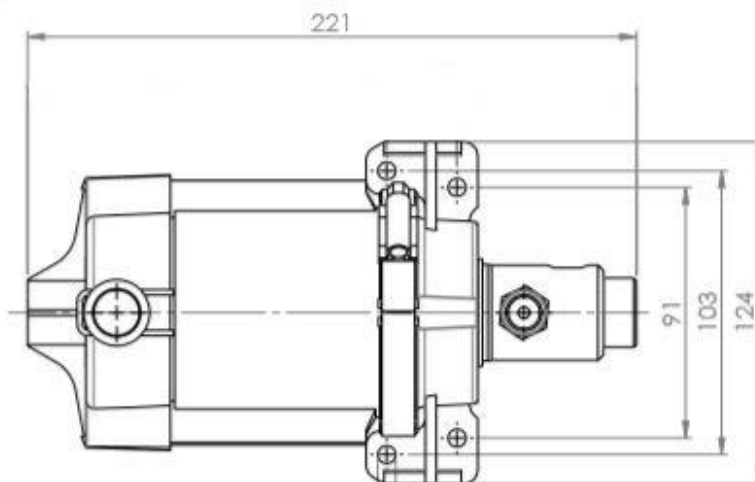

Series comparison:

Type	Output Max (bar)	Cyl	Tank (L)	Usable (L)	Flow w/out load (l/min)	Power supply	Flow with load (l/min)	Air range (bar)	Air consumpt (l/min)	Weight (kg)
UPF252-H2O	250	S.E.	2,4	2,1	8,5	Aria	0,7	2,8-8,3	180/390	6,7
UPM2510-H2O	250	D.E.	10	9,6	8,5	Aria	0,7	2,8-8,3	180/390	12,91
UPW250-H2O	250	S.E.	/	/	4,9	H2O	0,7	/	/	1,5

To order:

- P/N 915080040 UPW250 UP PUMP MOTOR WATER US

Spare parts:

SEAL KIT UPW250-H2O



All BELL products are designed and manufactured within BELL SRL in via F. De Pisis, 5 - 42124 Reggio Emilia (RE) - Italy, according to the Quality Standards that distinguish the MADE IN ITALY from the Rest of the World.

Diagrammi consumo aria (l/min) - (air consumption):

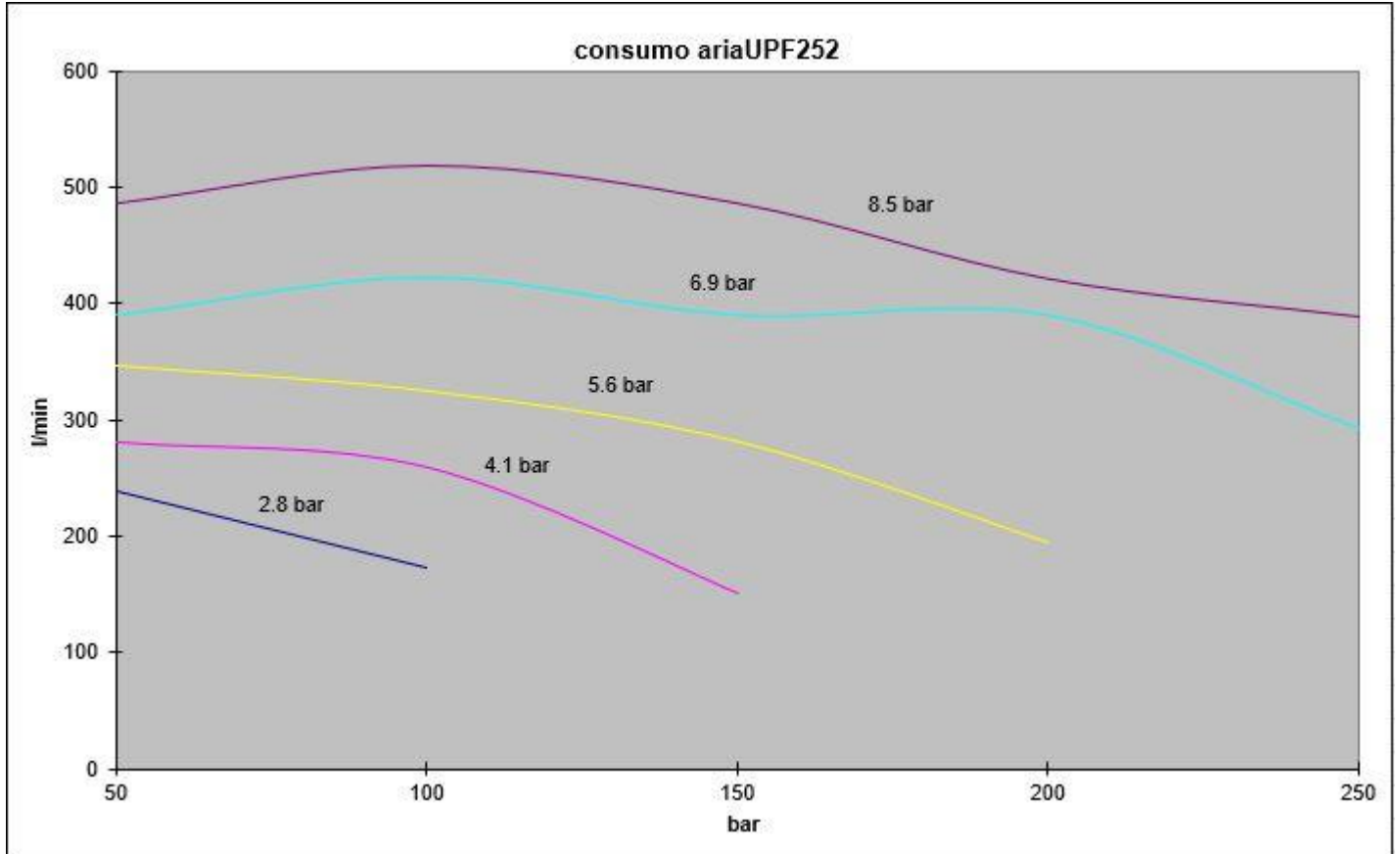

Diagrammi portata (l/min) - (oil flow):

